

## Self Check-in Information - Apartment 24/29 Orwell St. 公寓（Orwell 街 24/29）的自助入住讯息

Hi. We hope you had an easy arrival into to Sydney. We are sorry that we are not there to greet you in person. We placed a set of keys in a Key Safe attached around the corner / edge of the building, to the right of the front door. The Key safe is just 4 metres to the right of the front door of 29 Orwell Street, and just around the corner edge of the building. See where on the pictures enclosed.

你好. 我们希望你们到来时一切安排会简单化。抱歉，你们到来时这儿没有专人接待。我们把一套需用的钥匙放在公寓楼的墙的转弯处的一个保险盒里。如果你面对 Orwell 街 29 号的前门，这个保险盒就在此门右手四米远处的墙的转弯角边上。下面有图示。

### **A few quick comments before we get started.**

我们先简单说几点：

1. Call me 0416 016 999 or Chris on 0404 810 404 if you have any issues.
2. Please do not ask random people in the building, or anyone else in the area about these arrangements. It's Airbnb - they won't know about your booking.
3. Please do not ask the restaurant downstairs. The residential building is separate from the restaurant, please don't question their management or staff.
4. The key safe is our little secret, so please don't broadcast its location or its purpose.

- 1) 如果你们有任何问题，请给我 Charlotte 打电话（0416 016 999）或给 Chris 打电话（0404 810 404）。
- 2) 如有问题不要随便问楼里或楼外的其他人。这是 Airbnb. 其他人包括邻居都不知道你的预定的套房的任何情况。
- 3) 有问题也不要问楼下餐厅的任何人，不管他是管理人员或工作人员。我们住宅楼与餐厅没有任何关系。他们不知道住宅楼的如何情况。
- 4) 钥匙的保险盒是你我之间的一点小秘密。请不要广播它的位置和目的。

### **On Arrival find the door and walk to the Key Safe.**

在到达找上了门，步行到钥匙保险箱。

- Go to the front door of 29 Orwell Street.
- Walk 4 metres to right of the front corner edge of the building.
- The Key safe is just around the corner of the right hand edge of the building wall.
  
- 找到 Orwell 街 29 号。
- 面对大门，右转 90 度往前走四米是公寓楼的墙体的转角。
- 钥匙盒就在转角的另一边墙上。

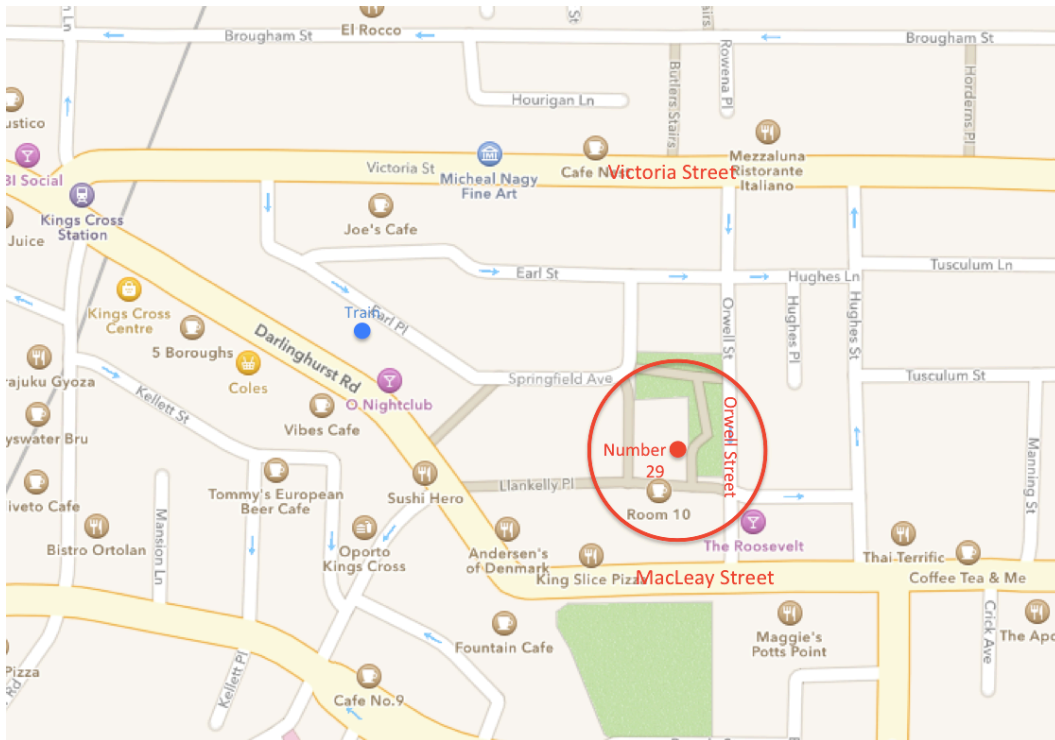

### Apartment Location on Orwell Street:

公寓楼在 **Orwell 街** 的位置:

- The Apartment is on the corner of Orwell Street and Llankey Place
- The apartment number is unit 24 / 29 Orwell St Potts Point 2011.
- Go to the 3<sup>rd</sup> floor, turn right from the top of the stairs.
- 公寓楼（Orwell 街 29 号）在 Orwell 街与 Llankey 巷的交叉口。
- 你的套房是 24 号。地址是: 24/29 Orwell Street, Potts Point, NSW 2011.
- 24 号房间在 3 楼。走到 3 楼，右转便是。

### Apartment Keys & Access:

公寓的进出与钥匙:

- You will now have 2 sets of keys. 1 set from the Key Safe and 1 set in the apartment.
- Leave ALL sets of keys in the apartment when you check out.
- Big triangular key accesses the in the Front Door & Security Gate.
- **To exit the building, please note Internal button to release gate to get out of the building. Its on top of the 5 steps once your inside the security gate.**
- To operate the intercom Hold any button for 10 seconds to allow visitor to clear the front door and security gate.
- **When you check-out leave all keys the table and pull the door.**
- 您将有两套钥匙：第一个是在建筑物外面，另一个是在房间里。
- 当你退房离开时，请把这三套钥匙全部放在套房的桌上。
- 用大三角型钥匙来打开公寓楼的大门与安全门。
- **要走出公寓楼时不需用钥匙。请按大门口楼梯（五级）上面边墙上的白色按钮。这样就打开了安全门与大门的电锁。**
- 当你有外人访问你时，你可按对讲机上的任何按钮 10 秒钟，让你的客人通过大门与安全门。
- 在退房时，把所有的钥匙放桌上，拉上房门即可。

## See the Blue Welcome / Guide-book on the table:

### 蓝色欢迎书及旅游指导:

The welcome book has the information you need (including most of this information). Take a quick flick through to see what you have there. The guide-book has our local recommendations café, gyms, restaurant suggestions, maps and our contact details.

蓝色欢迎书里大多数你需要的讯息。请浏览一下看看这儿有些什么。旅游指导里有我们对当地的咖啡店，健身房，餐厅的建议，地图，还有和我们联系的方法。

## This image shows where the key safe is from the front door.

此照片显示了钥匙保险盒离大门的距离与位置。它在楼墙转弯角的边上。



## This image shows the key safe just around the corner edge from the front door.

下面的照片显示了如何从保险盒里取出钥匙:

1. Pull down the cover and enter the 4 digit combination
2. Squeeze the two buttons on either side to release the door
3. Take the keys, shut the covers and re-scramble the combination lock.
4. The key safe is private so please don't share its location or its purpose.

(You might need the light from your mobile to see if its late)

1. 拉下最外面的盖子，输入4位数字的密码。
2. 同时按下盒子左右两边的按钮，打开盒子里面的盖子。
3. 取出钥匙，关上盒子的两层盖子，拨乱密码。
4. 钥匙的保险盒是你我之间的一点小秘密。请不要广播它的位置和目的。

(晚上您可能需要从您的手机取得光源)



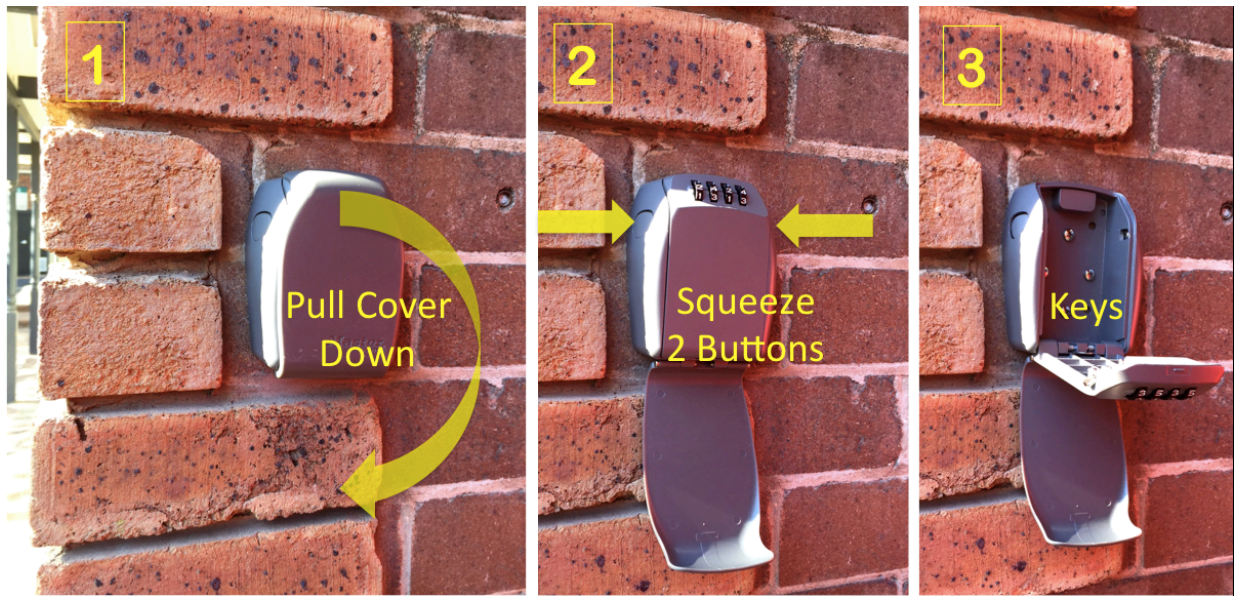

### A couple more important things you need to know 你需要知道的一些其他重要的事情。

**Once you inside the building, to exit the building, you need to push this button below to open the release the security gate.**

当你在楼里，需要出门时，请按入口楼梯上面墙上的白色按钮。这样就打开了安全门和大门的电锁。

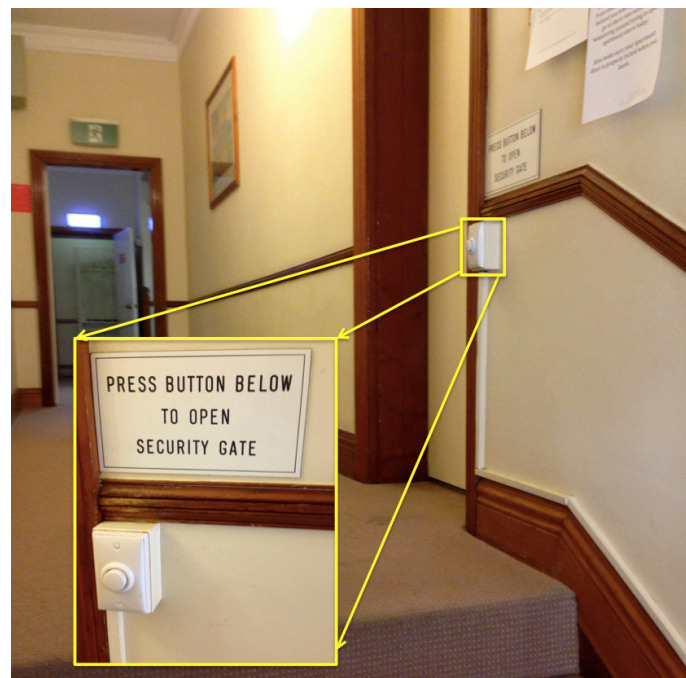

**Shoes off in the apartment would be appreciated.**  
我们将不胜感激如果你们在公寓脱掉外面的鞋。



PLEASE TAKE  
SHOES OFF

## Contact details for the unexpected

如遇意外情况时， 与我们的联系方式：

- “Whats App” (preferred) or text Charlotte on 0416 016999
  - Charlotte’s email : [contactcharlotte@gmail.com](mailto:contactcharlotte@gmail.com)
  - Chris’s email : [contactchris@hotmail.com](mailto:contactchris@hotmail.com) & 0404 810404
- 1) 请用 “Whats App”(我们的首选)， 或者发短讯给 Charlotte 的手机 0416 016 999.
  - 2) Charlotte 的电子信箱是： [contactcharlotte@gmail.com](mailto:contactcharlotte@gmail.com).
  - 3) Chris 的邮箱与手机是： [contactchris@hotmail.com](mailto:contactchris@hotmail.com), 0404 810 404.

## Internet & Phone.

互联网和电话：

- We hope that 2 GB of WiFi per day is plenty.
  - Please limit downloaded movies and TV shows to one per day.
  - The **WiFi Network name is 'Orwell'. Password is '24orwell'.**
- 我们希望每天 2 GB 的 WiFi 充足。
  - 将下载的电影和电视节目限制为每天一个。
  - WiFi 网络名称是 'Orwell'。 密码是 '13orwell'。

## Music, TV & DVD

音乐， 电视和 DVD

- Music Dock instructions are in this book and in the TV Cabinet.
  - TV has lots of local and National Channels.
  - DVD Player is in the TV and a couple of DVD’s provided. Set remote to DVD
  - Self Service DVD Rental Machine outside Harris Farm Supermarket.
- 音乐播放器的说明书在电视机柜子里。
  - 电视上有很多当地的和国家电视台的频道。
  - DVD 播放器也在柜子里。这儿有一些 DVD 碟子， 以及整套的遥控器。
  - 附近 Harris Farm 超市边上有 DVD 碟子的自助租赁机。

## Hot Water.

热水

- The hot water storage is small. Please allow for quick showers or allow 15 minutes between showers to reheat the hot water storage unit.
- 本单元里的热水箱不大。 请淋浴时快一点。 不同人用淋浴之间请相隔 15 分钟， 让热水重新冲满水箱。

## Fridge and food

冰箱和食品

- Help yourself to oils and condiments. Supplied to make it easy.
  - Organic Markets on Saturday in Fitzroy Gardens near fountain.
  - Harris Farm, at the other end of Llankelly Lane is excellent for supplies such as fresh food, pre-cooked meals and treats. Enter from Springfield Avenue or near the Greek Coffee shop on Llankelly Lane.
- 要用菜油和调味品， 请自便。
  - 每周六在喷泉附近的 Fitzroy 花园边上有有机蔬果市场。
  - Llankelly 巷的另一头是 Harris Farm 店， 那里有新鲜食品， 预煮的饭菜和零食。从 Spingfield 街或附近在 Llankelly 巷上的希腊咖啡馆都可进入。

## **Laundry**

### **洗衣机:**

- Laundry up one level. Coin operated with 3 x \$1 Coins + 1 x 20 Cent piece.
- I try and leave laundry powder under the kitchen sink.
- 洗衣机需用硬币启动。启动需放入三个一元硬币和一个 20 分的硬币。
- 洗衣粉在厨房水槽下面。

## **Check-Out Information.**

### **退房须知:**

- Check out time is 10 am on your date of departure. The cleaners will be scheduled to arrive this time to start work.
- If there are any spills, stains or breakages to report, please advise us the day before you leave so we can discuss what to do together.
- Please leave the keys on the table and close the door behind you
- 退房的时间是上午 10 时。清洁工会在此时到达开始工作。
- 如果有任何地毯弄脏，毛巾玷污或碗具家具损伤等，请告诉我们。这样在你们离开前我们可一起商量该做些什么。
- 离开时请把所有钥匙放桌上，并关上房门。