

## Self Check-in Information - Apartment 13/29 Orwell St.

Hi. We hope you had an easy arrival into Sydney. We are sorry that we are not there to greet you in person. We placed a set of keys in a Key Safe attached around the corner / edge of the building, to the right of the front door. The Key safe is just 4 metres to the right of the front door of 29 Orwell Street, and just around the corner edge of the building. See where on the pictures enclosed on the next page.

### A few quick comments before we get started.

1. Call me 0416 016 999 or Chris on 0404 810 404 if you have any issues.
2. Please do not ask random people in the building, or anyone else in the area about these arrangements. It's Airbnb - they won't know about your booking.
3. Please do not ask the restaurant downstairs. The residential building is separate from the restaurant, please don't question their management or staff.
4. The key safe is our little secret, so please don't broadcast its location or its purpose.

### On Arrival find the door and walk to the Key Safe.

- Go to the front door of 29 Orwell Street.
- Walk 4 metres to right of the front corner edge of the building.
- The Key safe is just around the corner of the right hand edge of the building wall.

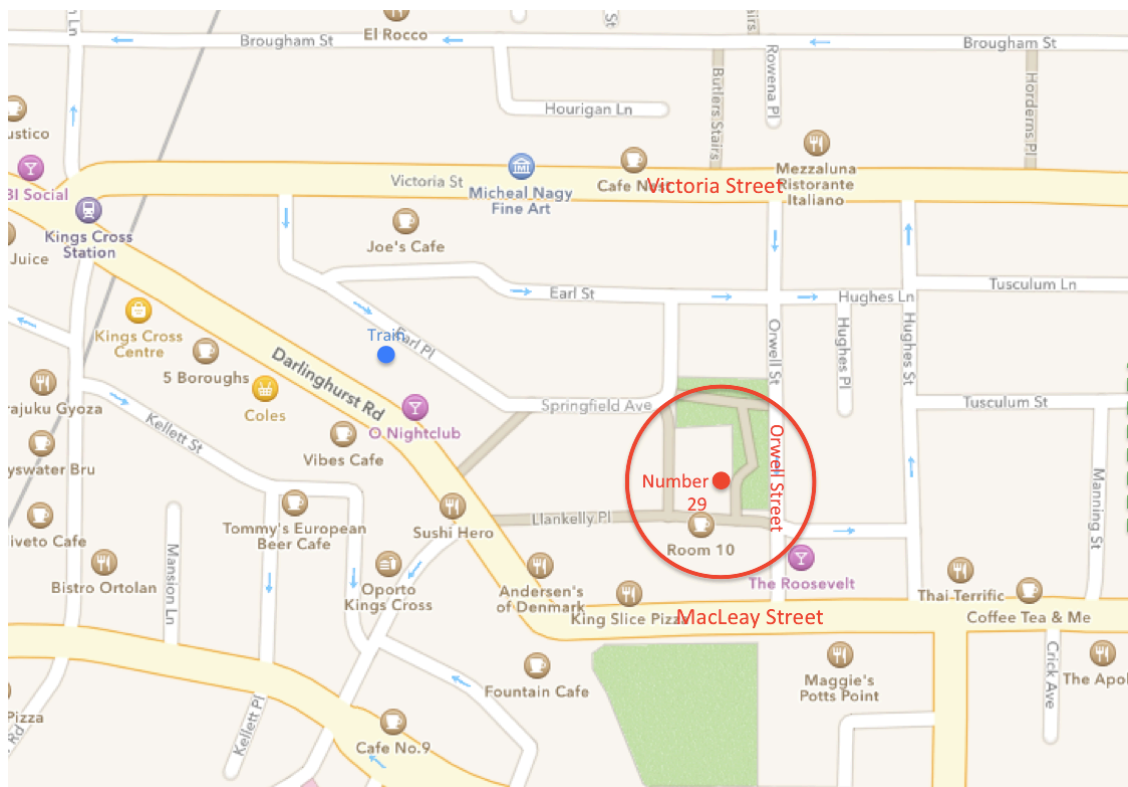

### Apartment Location on Orwell Street:

- The Apartment is on the corner of Orwell Street and Llankey Place
- The apartment number is unit 13 / 29 Orwell St Potts Point 2011.
- Go to the 1<sup>st</sup> floor, turn left from the first level of the stairs.

### Apartment Keys & Access:

- You will now have 2 sets of keys. 1 set from the Key Safe and 1 set in the apartment.
- Leave all Keys in the apartment when you check out.
- Big triangular key accesses the in the Front Door & Security Gate.

- To exit the building, please note Internal button to release gate to get out of the building. Its on top of the 5 steps once your inside the security gate.
- To operate the intercom Hold any button for 10 seconds to allow visitor to clear the front door and security gate.
- When you check-out leave all keys the table and pull the door.

**See the Blue Welcome / Guide-book on the table:**

The welcome booklet has the information you need (including most of this information). Take a quick flick through to see what you have there. The guide-book has our local recommendations café, gyms, restaurant suggestions, maps and our contact details.

**This image shows where the key safe is from the front door.**



**This image shows the key safe just around the corner edge from the front door.**

1. Pull down the cover and enter the 4 digit combination
2. Squeeze the two buttons on either side to release the door
3. Take the keys, shut the covers and re-scramble the combination lock.
4. The key safe is private so please don't share its location or its purpose.

(You might need the light from your mobile to see if its late)



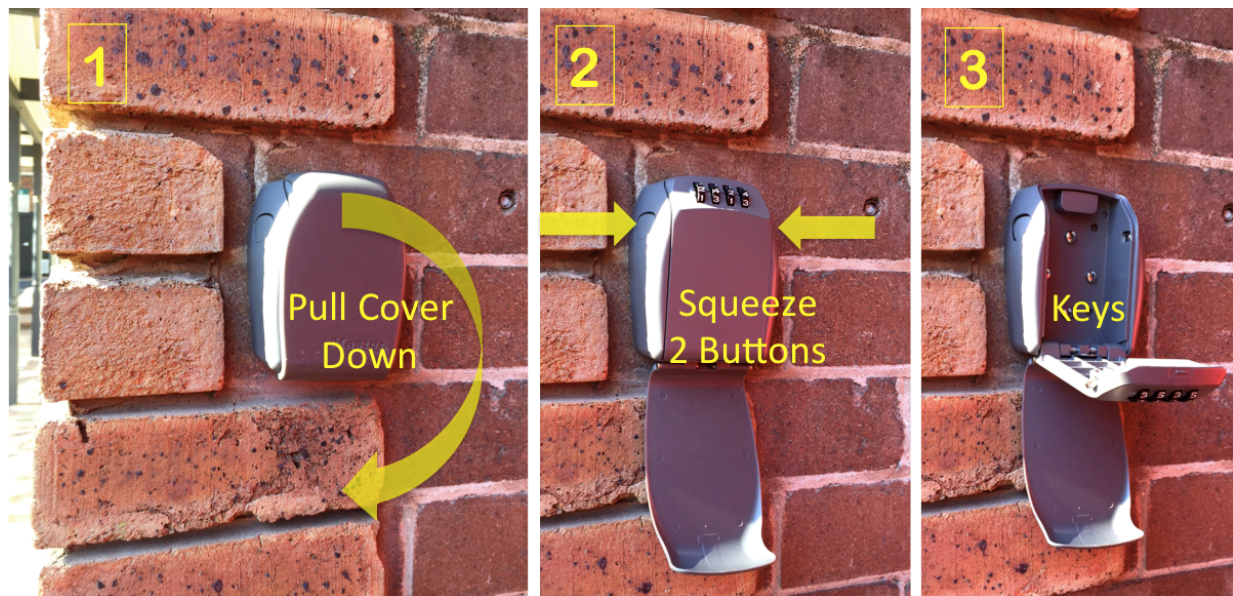

## A couple more important things you need to know.

Once you are inside the building, to exit the building, you need to push this button below to open the release the security gate.

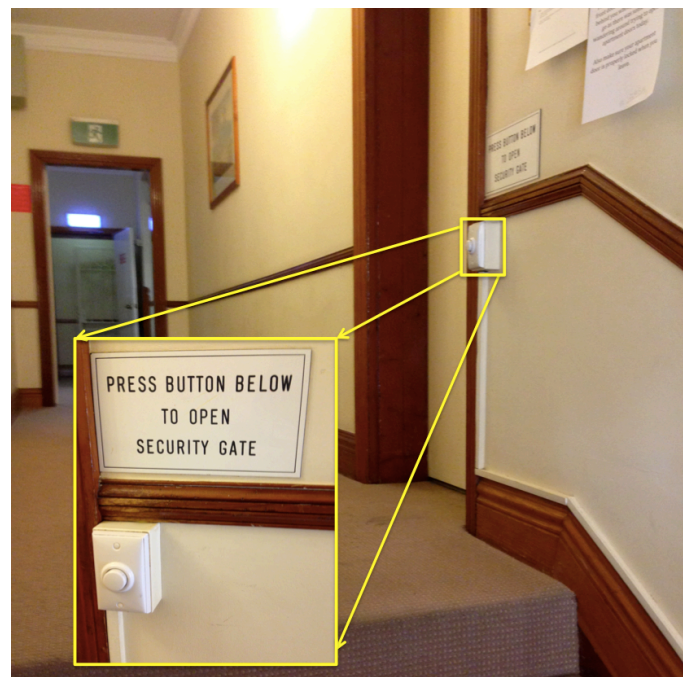

### Contact details for the unexpected

- "Whats App" (preferred) or text Charlotte on 0416 016999
- Charlotte's email : [contactcharlotte@gmail.com](mailto:contactcharlotte@gmail.com)
- Chris's email: [contactchris@hotmail.com](mailto:contactchris@hotmail.com) & 0404 810404

### Internet & Phone.

- We hope that 2 GB of WiFi per day is plenty.
- Please limit downloaded movies and TV shows to one per day.
- The **WiFi Network is 'Orwell'**. Password is **'13orwell'**.

### Hot Water.

- The hot water storage is small. Please allow for quick showers or allow 15 minutes between showers to reheat the hot water storage unit.

**Music, TV & DVD**

- Music Dock instructions are in this book and in the TV Cabinet.
- TV has lots of local and National Channels.
- DVD Player is in the TV and a couple of DVD's provided. Set remote to DVD
- Self Service DVD Rental Machine outside Harris Farm Supermarket.

**Fridge and food**

- Help yourself to oils and condiments. Supplied to make it easy.
- Fridge has a couple of things remaining. I clear out most items.
- Organic Markets on Saturday in Fitzroy Gardens near fountain.
- Tea & coffee is provided but the coffee is better down at Room 10 Cafe.
- Harris Farm, at the other end of Llankelly Lane is excellent for supplies such as fresh food, pre-cooked meals and treats. Enter from Springfield Avenue or near the Greek Coffee shop on Llankelly Lane.

**Laundry**

- Laundry up one level. Coin operated with 3 x \$1 Coins + 1 x 20 Cent piece.
- I try and leave laundry powder under the kitchen sink.

**Check-Out Information.**

- Check out time is 10 am on your date of departure. The cleaners will be scheduled to arrive this time to start work.
- If there are any spills, stains or breakages to report, please advise us the day before you leave so we can discuss what to do together.
- Please leave the keys on the table and close the door behind you